

SDA Getting Started Tutorial for the Dimensions CM plugin

The following document describes the installation and full sample usage scenario for the Dimensions CM plugin that can be implemented on an SDA installation. This document accompanies the SDA CM Plugin video on [KBTV](#).

Step 1: Download the plugin

Go to support.serena.com select **DOWNLOADS**, select the relevant SDA product, and select the relevant operating system. In the section entitled SDA Plugins, select the download link next for Dimensions CM Plug-in.

Step 2: Install the plugin

Login to SDA go to **Administration | Automation | Automation Plugins** and click on the **Load Plugin** button, browse to the downloaded zip file and click on **Submit** and the Dimensions CM plugin should now appear.



Plugin	Description	Version	Actions
Zip	Plugin which provides a step to extract Zip archives.	2_134	Delete
Dimensions CM	The Dimensions CM plugin integrates Serena RA with Dimensions CM. It allows users to retrieve information from the Dimensions CM server and perform various baseline and project operations.	5_123	Delete

Step 3: Create a generic process to test the plugin

TIP: A generic process is a great method for testing plugin functionality or any other general process functionality.

In SDA go to **Management | Processes (1)** click on **Create Process (2)** specify the Name as CMTest and then click on **Save**.

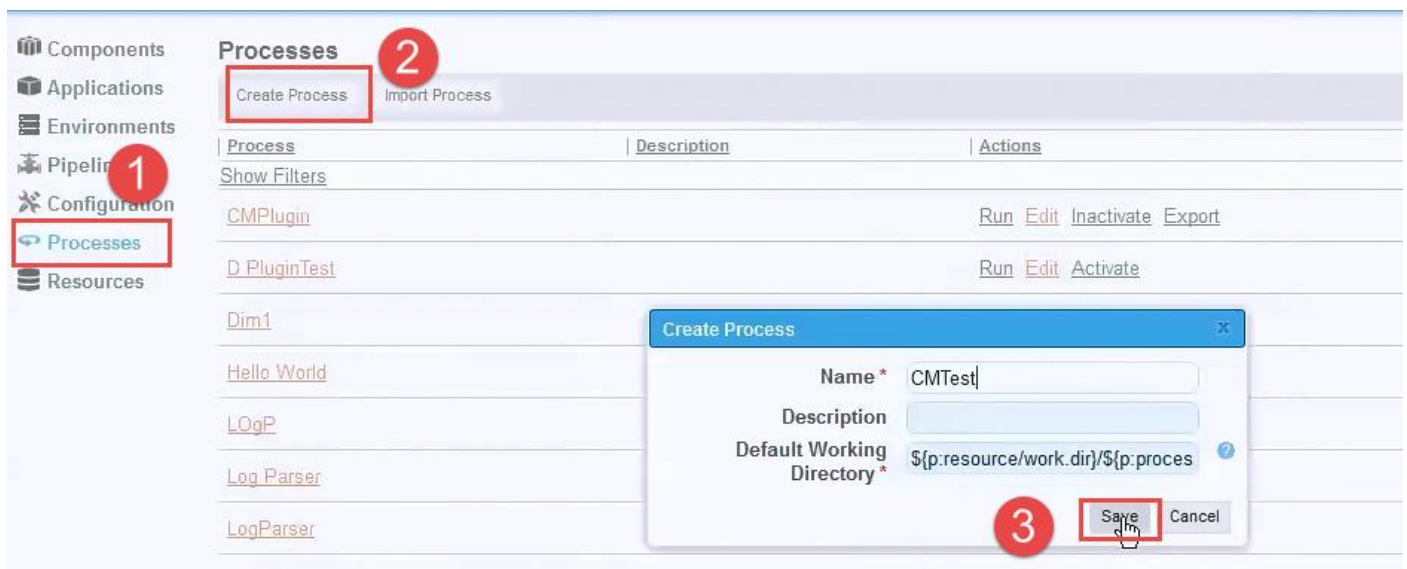

The screenshot shows the SDA interface with the 'Processes' section selected in the left sidebar. A 'Create Process' dialog box is open, showing the following fields:

- Name *: CMTest
- Description: (empty)
- Default Working Directory *: \${p.resource/work.dir}/\${p.proces

The 'Save' button in the dialog is highlighted with a red box and a red circle with the number 3. The 'Create Process' button in the main interface is highlighted with a red box and a red circle with the number 2. The 'Processes' menu item in the sidebar is highlighted with a red box and a red circle with the number 1.

Click on the **Design** tab and under the Available Plugin Steps select **Utilities | FileUtils | Create File** place it at the beginning of the flow

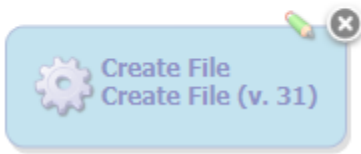
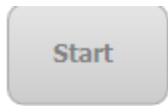

Populate the form as below

Name: Create File

Contents: File content

Then click on **Save**.

The "Edit Properties" dialog box for the "Create File" plugin. It has a blue title bar with the text "Edit Properties" and a close button (X). The form contains several fields and checkboxes. The "Name" field is set to "Create File" and is highlighted with a red box and a red circle with the number "1". The "File Name" field is set to "Set a value here". The "Contents" field is a large text area containing "File content" and is highlighted with a red box and a red circle with the number "2". Below the "Contents" field are two "Prompt for a value on use" labels, each with a blue question mark icon. The "Overwrite if exists" and "Allow Failure" checkboxes are unchecked. The "Working Directory" field is empty. The "Post Processing Script" field has a dropdown menu set to "Step Default" and a "Create" button. The "Precondition" field is empty. At the bottom, there are "Use Impersonation" and "Show Hidden Properties" checkboxes, both unchecked. A red circle with the number "3" is positioned above the "Save" button, which is highlighted with a red box. A "Cancel" button is located to the right of the "Save" button.

Join

Under the Available Plugin Steps select **Integration | Serena | Dimensions CM** and select the step **Upload File or Directory** and place this below the Create File Step

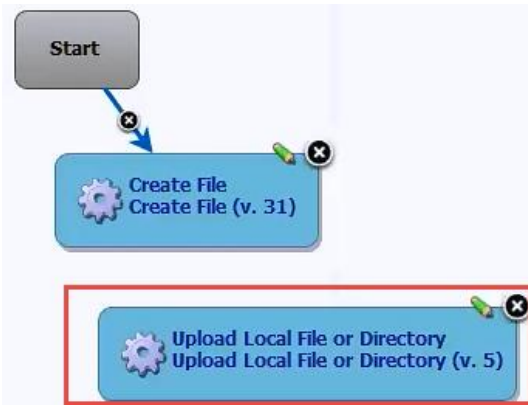

Fill out the required login details to match the current login setting required to login to the CM server to access the CM_TYPICAL base database, an example is shown below.

Specify the Project Name as: SDA_TEST

Field	Value
Name *	Upload Local File or Directory
User ID *	dmsys
Password
Server *	pc-st-w28k
DB name *	cm_typical
DB Connection *	dim12
Directory *	.
Product name *	QLARIUS
Project name *	SDA_TEST
Attributes	

Scroll further down and specify the description as below

Description	Uploaded from the CM plugin from SDA
-------------	--------------------------------------

Scroll to the bottom of the dialog and click on **Save** to store the new step.

Join the Create File to the Upload File or Directory step.

Login to the CM Client and create a new Project called **SDA_TEST** and click on **Next**.

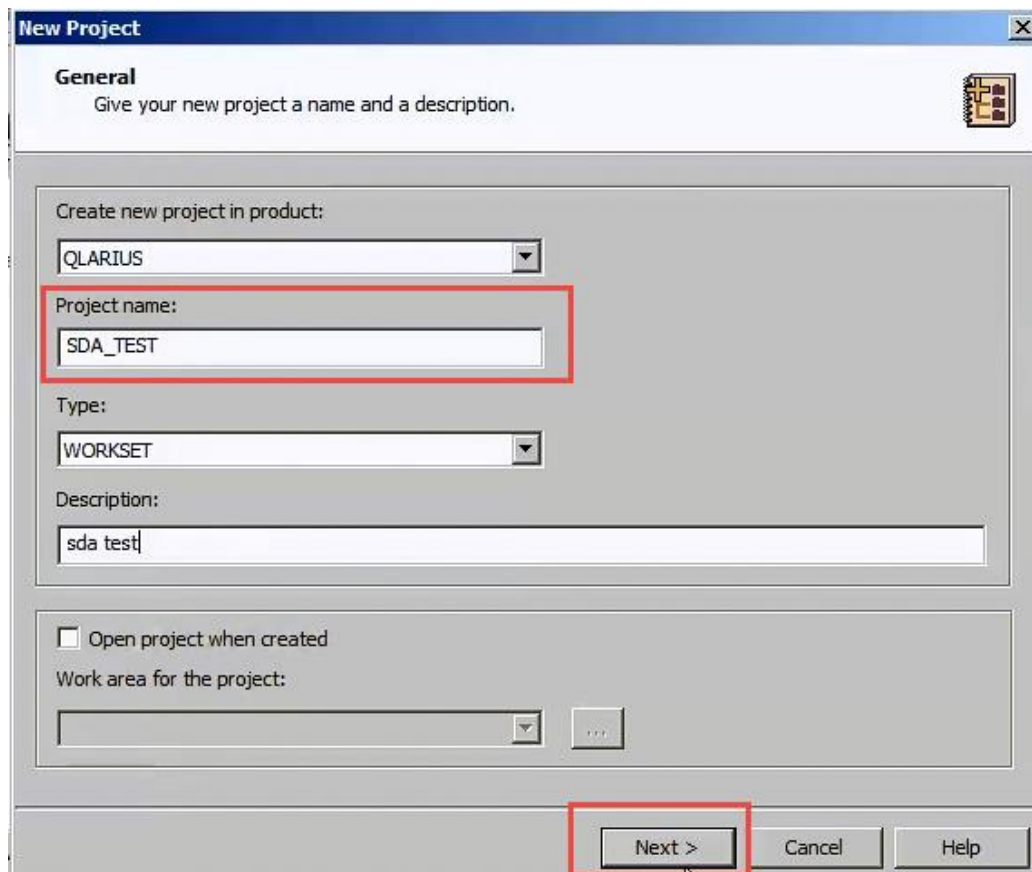

Specify an **empty project** and click on **Finish**

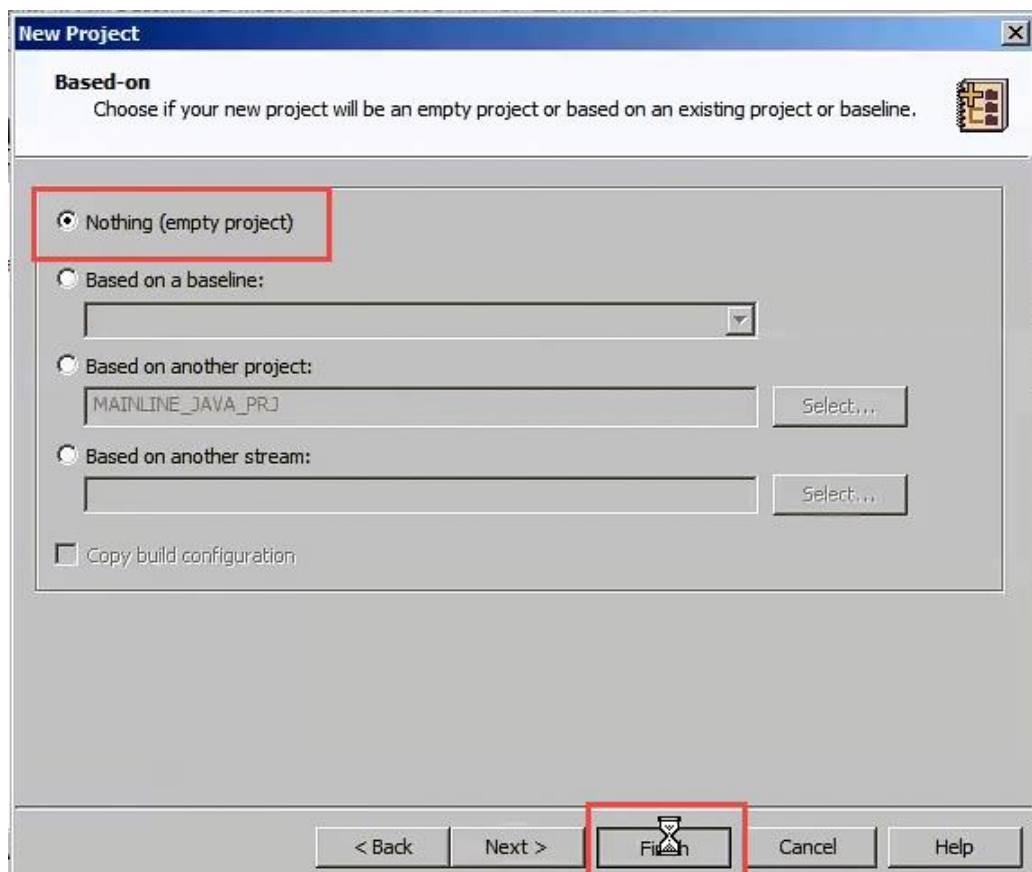

Open the SDA_TEST project in client and minimise the client session.

Return to the SDA screen, under the Available Plugin Steps select **Integration | Serena | Dimensions CM** and select the step **Create Baseline** and place this below the Upload File or Directory step.

Fill out the screen as below:

Ensure that the login details match the current Dimensions CM server

For **Baseline Name** click on **Prompt for a value on use** which will then display set a value here

For **Baseline Type** specify the value **BASELINE**

Edit Properties

Name *	Create Baseline
User ID *	dmsys Prompt for a value on use
Password	••••• Prompt for a value on use
Server *	pc-st-w28k Prompt for a value on use
DB name *	cm_typical Prompt for a value on use
DB Connection *	dim12 Prompt for a value on use
Product Name *	QLARIUS Prompt for a value on use
Based on *	SDA_TEST Prompt for a value on use
Baseline Name	Set a value here
Baseline Type *	BASELINE Prompt for a value on use

Attributes

Scroll down and click on the **Save** button and join the remaining steps and click on the disc icon:  under **Tools** to save the design.

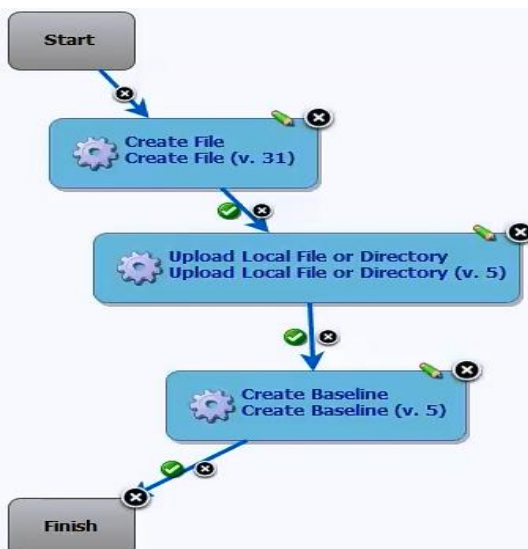

Step 4: Run the process

Go to the Dashboard Tab, and specify the following as shown in the screenshot below

File Name: **test_file_one.java**

Baseline Name: **SDA_TEST_BASELINE_NO1**

Then click on **Submit**

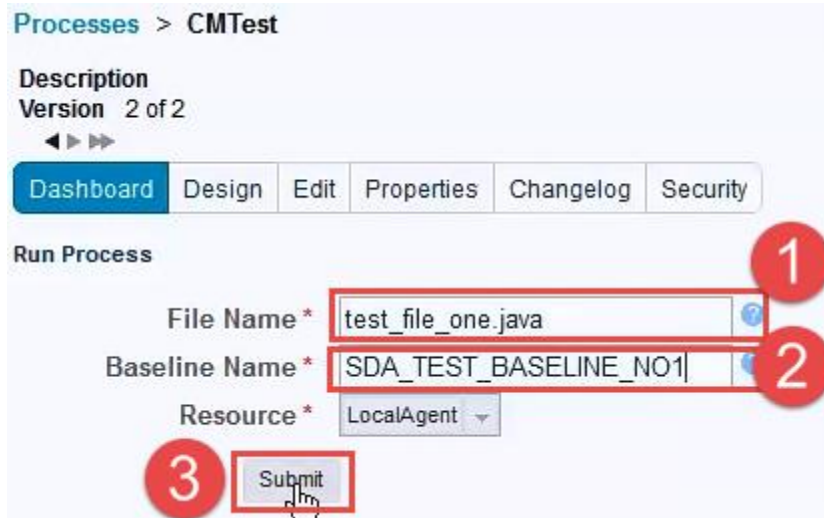

After a minute or so the 3 steps should complete

Step	Type	Start	Duration	Status	Action
Create File	File Utils v. 31_164	10:02:03 AM	0:00:06	Success	
Upload Local File or Directory	DimensionsCM v. 5_123	10:02:08 AM	0:00:10	Success	
Create Baseline	DimensionsCM v. 5_123	10:02:18 AM	0:00:09	Success	
Total Execution		10:02:03 AM	0:00:25	Success	

Switch to the Dimensions client and refresh the view by select **View | Refresh | All views**. The file test_file_one.java should now appear in the SDA_TEST project as below:

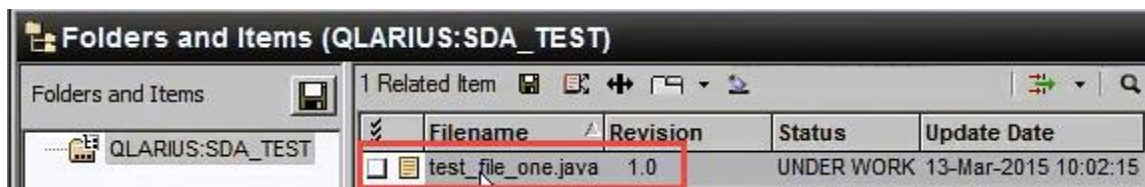

Select the Baseline Catalogue view and the baseline should appear containing the aforementioned file:

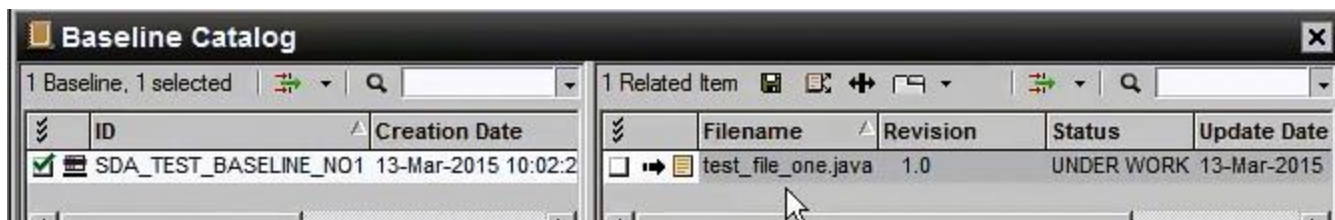

End of document